



**SF PA Series | Palletizing Robot**  
**Model: SF130-K2700**

The SF PA series is fast, accurate, and powerful CHAIFU industrial robots for pallet stacking on the market. A complete product portfolio obtains higher economic benefits, high precision, low cost, and very efficient productivity.

The SF PA series for palletizing, handling, and stamping industrial applications offers unparalleled productivity and high performance in the market, completing a wide range of complete solutions quickly and precisely, with a low deadweight design to reduce cycle times.

With its low cost and high productivity, the SF PA is the perfect choice to benefit from the efficiency of your plant by achieving a total capacity increase with fast and accurate output in a small space.

**Applications**

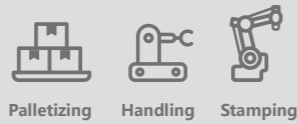

Palletizing Handling Stamping

**SF130-K2700 Data Overview**

<b>Model</b>	SF130-K2700	
<b>Structure</b>	Vertically Articulated	
<b>Number of Axis</b>	4	
<b>Radius</b>	2735mm	
<b>Payload</b>	130kg	
<b>Repeatability</b>	±0.25mm	
<b>Drive Mode</b>	AC Servo Motor	
<b>Maximum Speed</b>	J1	178° /s
	J2	112° /s
	J3	105° /s
	J4	340° /s
	J5	/
	J6	/
<b>Range of Motion</b>	J1	+/-180°
	J2	+45° /-90°
	J3	+85° /-55°
	J4	±360°
	J2 + J3	-105° ≤ J2 + J3 ≤ 25°
<b>Allowable Moment</b>	J4	1764N.M
	J5	/
	J6	/
<b>Allowable Inertia</b>	J4	36kg.m2
	J5	/
	J6	/
<b>Protection Rating</b>	IP 65, Wrist IP 67	
<b>Operating Conditions</b>	Temp.	0-45°C
	Humidity	Below 95%RH
	Vibration	Below 4.9m/s2
	Other	Eliminate Signal Noise
<b>Base Size</b>	620*620mm	
<b>Height</b>	2073mm	
<b>Weight</b>	1160KG	
<b>Mounting Positions</b>	Floor	
<b>Power Consumption</b>	5.5kVA	

**SF130-K2700 Range of Motion**

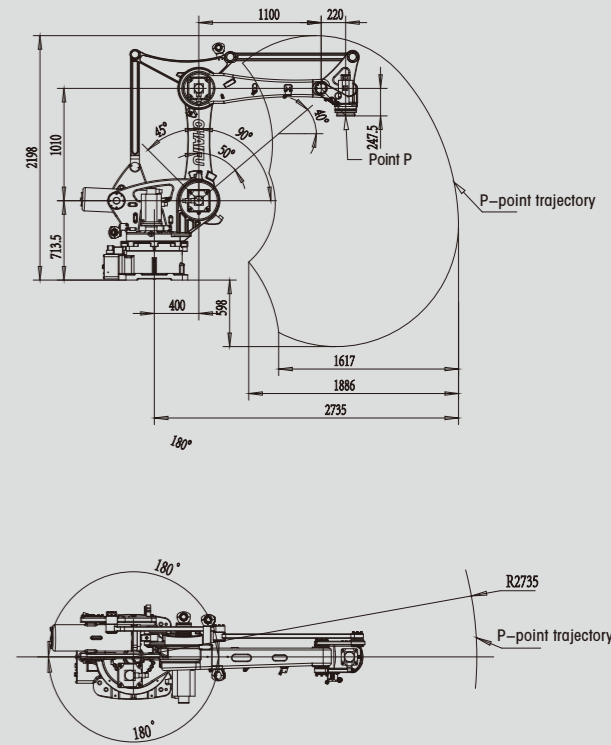

**External & Installation Dimensions**

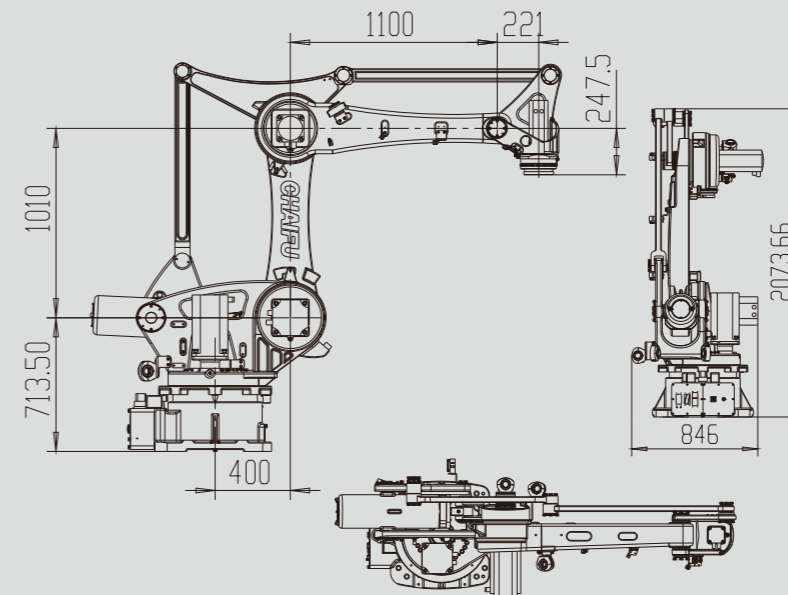

**A-Way Diagram (End Flange Mounting Dimensions)**

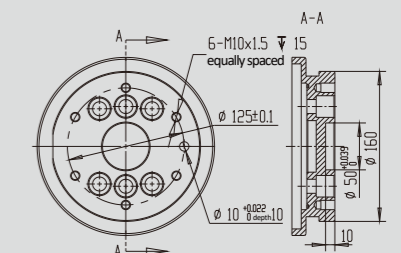

**B-Way Diagram (Base Mounting Dimensions)**

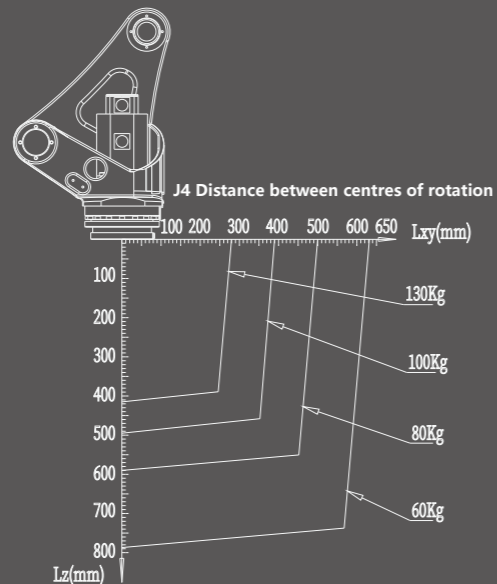
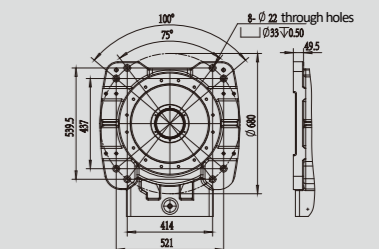

SF130-K2700 Wrist load torque chart